



City of Port Moody

Bylaw No. 3267

A Bylaw to apply the Medium Density Townhouse Residential (RM4) zone to the properties previously subject to a Land Use Contract for Balmoral Place.

The Council of the City of Port Moody enacts as follows:

1. Citation

- 1.1 This Bylaw may be cited as “City of Port Moody Zoning Bylaw, 2018, No. 2937, Amendment Bylaw No. 44, 2020, No. 3267 (RM4 LUC Termination)”.

2. Amendments

- 2.1 City of Port Moody Zoning Bylaw, 2018, No. 2937 is amended by rezoning the lands outlined in the following schedule to Medium Density Townhouse Residential (RM4):
 - Schedule A – Balmoral Place Map and List of Properties

3. Attachments and Schedules

- 3.1 The following schedule is attached to and forms part of this Bylaw:
 - Schedule A – Balmoral Place Map and List of Properties

4. Severability

- 4.1 If a portion of this Bylaw is found invalid by a court, it will be severed and the remainder of the Bylaw will remain in effect.

Read a first time this 8th day of September, 2020.

Read a second time this 8th day of September, 2020.

Public Hearing held this ____ day of _____, 2020.

Read a third time this ____ day of _____, 2020.

Adopted this ____ day of _____, 2020.

R. Vagramov
Mayor

D. Shermer
Corporate Officer

I hereby certify that the above is a true copy of Bylaw No. 3267 of the City of Port Moody.

D. Shermer
Corporate Officer

Schedule A – Balmoral Place Map and List of Properties

Map

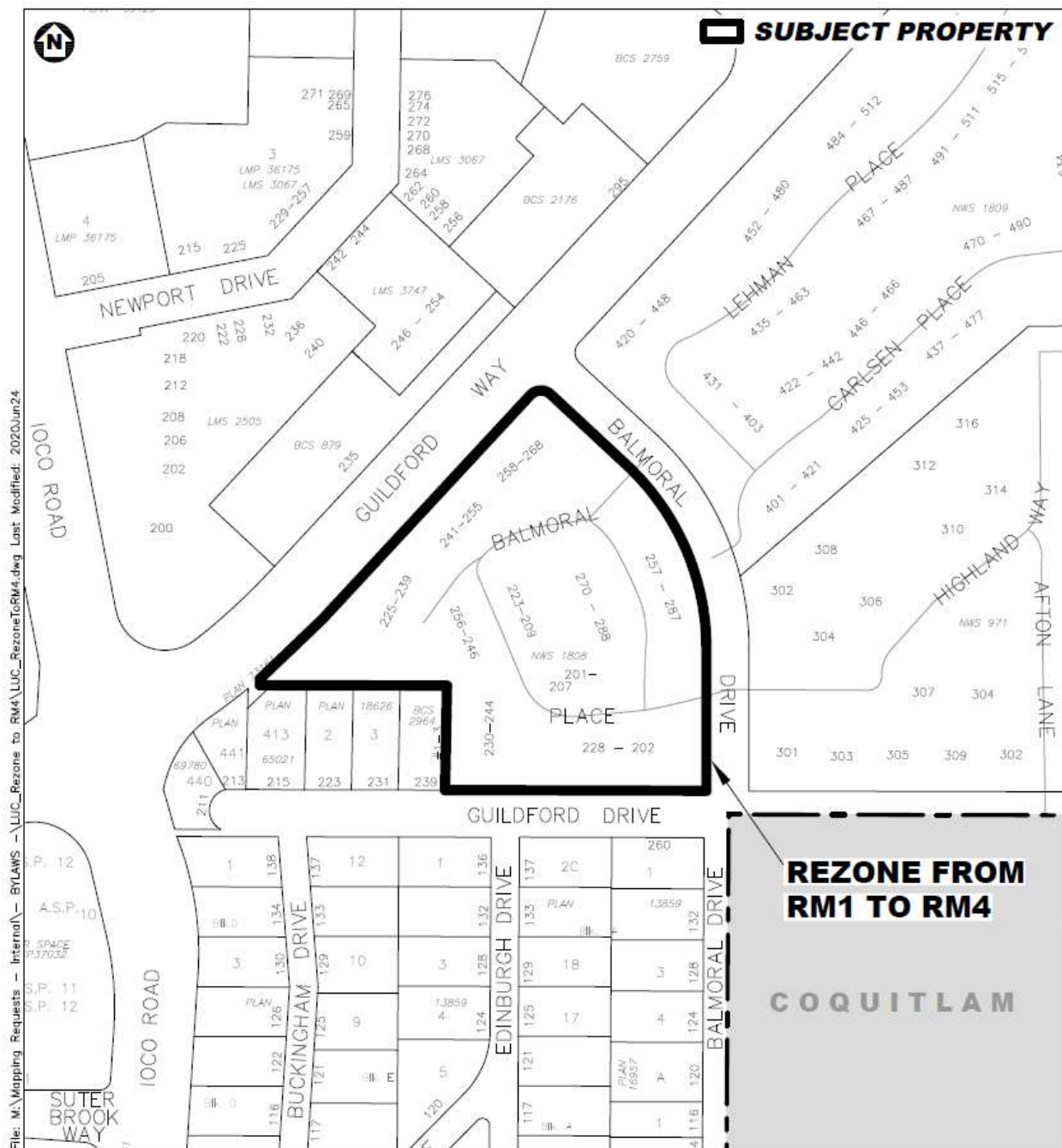

Schedule A

List of Properties

Address	P.I.D.	Legal Description
201 BALMORAL PL	002-007-860	STRATA LOT 40, DISTRICT LOT 470, GROUP 1, NEW WESTMINSTER DISTRICT STRATA PLAN NW1808 TOGETHER WITH AN INTEREST IN THE COMMON PROPERTY IN PROPORTION TO THE UNIT ENTITLEMENT OF THE STRATA LOT AS SHOWN ON FORM V
202 BALMORAL PL	002-007-339	STRATA LOT 1, DISTRICT LOT 470, GROUP 1, NEW WESTMINSTER DISTRICT STRATA PLAN NW1808 TOGETHER WITH AN INTEREST IN THE COMMON PROPERTY IN PROPORTION TO THE UNIT ENTITLEMENT OF THE STRATA LOT AS SHOWN ON FORM V
203 BALMORAL PL	002-007-835	STRATA LOT 39, DISTRICT LOT 470, GROUP 1, NEW WESTMINSTER DISTRICT STRATA PLAN NW1808 TOGETHER WITH AN INTEREST IN THE COMMON PROPERTY IN PROPORTION TO THE UNIT ENTITLEMENT OF THE STRATA LOT AS SHOWN ON FORM V
204 BALMORAL PL	002-007-347	STRATA LOT 2, DISTRICT LOT 470, GROUP 1, NEW WESTMINSTER DISTRICT STRATA PLAN NW1808 TOGETHER WITH AN INTEREST IN THE COMMON PROPERTY IN PROPORTION TO THE UNIT ENTITLEMENT OF THE STRATA LOT AS SHOWN ON FORM V
205 BALMORAL PL	002-007-827	STRATA LOT 38, DISTRICT LOT 470, GROUP 1, NEW WESTMINSTER DISTRICT STRATA PLAN NW1808 TOGETHER WITH AN INTEREST IN THE COMMON PROPERTY IN PROPORTION TO THE UNIT ENTITLEMENT OF THE STRATA LOT AS SHOWN ON FORM V
206 BALMORAL PL	002-007-355	STRATA LOT 3, DISTRICT LOT 470, GROUP 1, NEW WESTMINSTER DISTRICT STRATA PLAN NW1808 TOGETHER WITH AN INTEREST IN THE COMMON PROPERTY IN PROPORTION TO THE UNIT ENTITLEMENT OF THE STRATA LOT AS SHOWN ON FORM V
207 BALMORAL PL	002-007-819	STRATA LOT 37, DISTRICT LOT 470, GROUP 1, NEW WESTMINSTER DISTRICT STRATA PLAN NW1808 TOGETHER WITH AN INTEREST IN THE COMMON PROPERTY IN PROPORTION TO THE UNIT ENTITLEMENT OF THE STRATA LOT AS SHOWN ON FORM V

Schedule A

Address	P.I.D.	Legal Description
208 BALMORAL PL	002-007-363	STRATA LOT 4, DISTRICT LOT 470, GROUP 1, NEW WESTMINSTER DISTRICT STRATA PLAN NW1808 TOGETHER WITH AN INTEREST IN THE COMMON PROPERTY IN PROPORTION TO THE UNIT ENTITLEMENT OF THE STRATA LOT AS SHOWN ON FORM V
209 BALMORAL PL	002-007-801	STRATA LOT 36, DISTRICT LOT 470, GROUP 1, NEW WESTMINSTER DISTRICT STRATA PLAN NW1808 TOGETHER WITH AN INTEREST IN THE COMMON PROPERTY IN PROPORTION TO THE UNIT ENTITLEMENT OF THE STRATA LOT AS SHOWN ON FORM V
210 BALMORAL PL	002-007-371	STRATA LOT 5, DISTRICT LOT 470, GROUP 1, NEW WESTMINSTER DISTRICT STRATA PLAN NW1808 TOGETHER WITH AN INTEREST IN THE COMMON PROPERTY IN PROPORTION TO THE UNIT ENTITLEMENT OF THE STRATA LOT AS SHOWN ON FORM V
211 BALMORAL PL	002-007-797	STRATA LOT 35, DISTRICT LOT 470, GROUP 1, NEW WESTMINSTER DISTRICT STRATA PLAN NW1808 TOGETHER WITH AN INTEREST IN THE COMMON PROPERTY IN PROPORTION TO THE UNIT ENTITLEMENT OF THE STRATA LOT AS SHOWN ON FORM V
212 BALMORAL PL	002-007-380	STRATA LOT 6, DISTRICT LOT 470, GROUP 1, NEW WESTMINSTER DISTRICT STRATA PLAN NW1808 TOGETHER WITH AN INTEREST IN THE COMMON PROPERTY IN PROPORTION TO THE UNIT ENTITLEMENT OF THE STRATA LOT AS SHOWN ON FORM V
213 BALMORAL PL	002-007-789	STRATA LOT 34, DISTRICT LOT 470, GROUP 1, NEW WESTMINSTER DISTRICT STRATA PLAN NW1808 TOGETHER WITH AN INTEREST IN THE COMMON PROPERTY IN PROPORTION TO THE UNIT ENTITLEMENT OF THE STRATA LOT AS SHOWN ON FORM V
214 BALMORAL PL	002-007-398	STRATA LOT 7, DISTRICT LOT 470, GROUP 1, NEW WESTMINSTER DISTRICT STRATA PLAN NW1808 TOGETHER WITH AN INTEREST IN THE COMMON PROPERTY IN PROPORTION TO THE UNIT ENTITLEMENT OF THE STRATA LOT AS SHOWN ON FORM V

Schedule A

Address	P.I.D.	Legal Description
215 BALMORAL PL	002-007-746	STRATA LOT 33, DISTRICT LOT 470, GROUP 1, NEW WESTMINSTER DISTRICT STRATA PLAN NW1808 TOGETHER WITH AN INTEREST IN THE COMMON PROPERTY IN PROPORTION TO THE UNIT ENTITLEMENT OF THE STRATA LOT AS SHOWN ON FORM V
216 BALMORAL PL	002-007-401	STRATA LOT 8, DISTRICT LOT 470, GROUP 1, NEW WESTMINSTER DISTRICT STRATA PLAN NW1808 TOGETHER WITH AN INTEREST IN THE COMMON PROPERTY IN PROPORTION TO THE UNIT ENTITLEMENT OF THE STRATA LOT AS SHOWN ON FORM V
217 BALMORAL PL	002-007-738	STRATA LOT 32, DISTRICT LOT 470, GROUP 1, NEW WESTMINSTER DISTRICT STRATA PLAN NW1808 TOGETHER WITH AN INTEREST IN THE COMMON PROPERTY IN PROPORTION TO THE UNIT ENTITLEMENT OF THE STRATA LOT AS SHOWN ON FORM V
218 BALMORAL PL	002-007-436	STRATA LOT 9, DISTRICT LOT 470, GROUP 1, NEW WESTMINSTER DISTRICT STRATA PLAN NW1808 TOGETHER WITH AN INTEREST IN THE COMMON PROPERTY IN PROPORTION TO THE UNIT ENTITLEMENT OF THE STRATA LOT AS SHOWN ON FORM V
219 BALMORAL PL	002-007-720	STRATA LOT 31, DISTRICT LOT 470, GROUP 1, NEW WESTMINSTER DISTRICT STRATA PLAN NW1808 TOGETHER WITH AN INTEREST IN THE COMMON PROPERTY IN PROPORTION TO THE UNIT ENTITLEMENT OF THE STRATA LOT AS SHOWN ON FORM V
220 BALMORAL PL	002-007-444	STRATA LOT 10, DISTRICT LOT 470, GROUP 1, NEW WESTMINSTER DISTRICT STRATA PLAN NW1808 TOGETHER WITH AN INTEREST IN THE COMMON PROPERTY IN PROPORTION TO THE UNIT ENTITLEMENT OF THE STRATA LOT AS SHOWN ON FORM V
221 BALMORAL PL	002-007-711	STRATA LOT 30, DISTRICT LOT 470, GROUP 1, NEW WESTMINSTER DISTRICT STRATA PLAN NW1808 TOGETHER WITH AN INTEREST IN THE COMMON PROPERTY IN PROPORTION TO THE UNIT ENTITLEMENT OF THE STRATA LOT AS SHOWN ON FORM V

Schedule A

Address	P.I.D.	Legal Description
222 BALMORAL PL	002-007-452	STRATA LOT 11, DISTRICT LOT 470, GROUP 1, NEW WESTMINSTER DISTRICT STRATA PLAN NW1808 TOGETHER WITH AN INTEREST IN THE COMMON PROPERTY IN PROPORTION TO THE UNIT ENTITLEMENT OF THE STRATA LOT AS SHOWN ON FORM V
223 BALMORAL PL	002-007-690	STRATA LOT 29, DISTRICT LOT 470, GROUP 1, NEW WESTMINSTER DISTRICT STRATA PLAN NW1808 TOGETHER WITH AN INTEREST IN THE COMMON PROPERTY IN PROPORTION TO THE UNIT ENTITLEMENT OF THE STRATA LOT AS SHOWN ON FORM V
224 BALMORAL PL	002-007-461	STRATA LOT 12, DISTRICT LOT 470, GROUP 1, NEW WESTMINSTER DISTRICT STRATA PLAN NW1808 TOGETHER WITH AN INTEREST IN THE COMMON PROPERTY IN PROPORTION TO THE UNIT ENTITLEMENT OF THE STRATA LOT AS SHOWN ON FORM V
225 BALMORAL PL	002-008-581	STRATA LOT 88, DISTRICT LOT 470, GROUP 1, NEW WESTMINSTER DISTRICT STRATA PLAN NW1808 TOGETHER WITH AN INTEREST IN THE COMMON PROPERTY IN PROPORTION TO THE UNIT ENTITLEMENT OF THE STRATA LOT AS SHOWN ON FORM V
226 BALMORAL PL	002-007-479	STRATA LOT 13, DISTRICT LOT 470, GROUP 1, NEW WESTMINSTER DISTRICT STRATA PLAN NW1808 TOGETHER WITH AN INTEREST IN THE COMMON PROPERTY IN PROPORTION TO THE UNIT ENTITLEMENT OF THE STRATA LOT AS SHOWN ON FORM V
227 BALMORAL PL	002-008-572	STRATA LOT 87, DISTRICT LOT 470, GROUP 1, NEW WESTMINSTER DISTRICT STRATA PLAN NW1808 TOGETHER WITH AN INTEREST IN THE COMMON PROPERTY IN PROPORTION TO THE UNIT ENTITLEMENT OF THE STRATA LOT AS SHOWN ON FORM V
228 BALMORAL PL	002-007-495	STRATA LOT 14, DISTRICT LOT 470, GROUP 1, NEW WESTMINSTER DISTRICT STRATA PLAN NW1808 TOGETHER WITH AN INTEREST IN THE COMMON PROPERTY IN PROPORTION TO THE UNIT ENTITLEMENT OF THE STRATA LOT AS SHOWN ON FORM V

Schedule A

Address	P.I.D.	Legal Description
229 BALMORAL PL	002-008-556	STRATA LOT 86, DISTRICT LOT 470, GROUP 1, NEW WESTMINSTER DISTRICT STRATA PLAN NW1808 TOGETHER WITH AN INTEREST IN THE COMMON PROPERTY IN PROPORTION TO THE UNIT ENTITLEMENT OF THE STRATA LOT AS SHOWN ON FORM V
230 BALMORAL PL	002-007-509	STRATA LOT 15, DISTRICT LOT 470, GROUP 1, NEW WESTMINSTER DISTRICT STRATA PLAN NW1808 TOGETHER WITH AN INTEREST IN THE COMMON PROPERTY IN PROPORTION TO THE UNIT ENTITLEMENT OF THE STRATA LOT AS SHOWN ON FORM V
231 BALMORAL PL	002-008-548	STRATA LOT 85, DISTRICT LOT 470, GROUP 1, NEW WESTMINSTER DISTRICT STRATA PLAN NW1808 TOGETHER WITH AN INTEREST IN THE COMMON PROPERTY IN PROPORTION TO THE UNIT ENTITLEMENT OF THE STRATA LOT AS SHOWN ON FORM V
232 BALMORAL PL	002-007-517	STRATA LOT 16, DISTRICT LOT 470, GROUP 1, NEW WESTMINSTER DISTRICT STRATA PLAN NW1808 TOGETHER WITH AN INTEREST IN THE COMMON PROPERTY IN PROPORTION TO THE UNIT ENTITLEMENT OF THE STRATA LOT AS SHOWN ON FORM V
233 BALMORAL PL	002-008-530	STRATA LOT 84, DISTRICT LOT 470, GROUP 1, NEW WESTMINSTER DISTRICT STRATA PLAN NW1808 TOGETHER WITH AN INTEREST IN THE COMMON PROPERTY IN PROPORTION TO THE UNIT ENTITLEMENT OF THE STRATA LOT AS SHOWN ON FORM V
234 BALMORAL PL	002-007-525	STRATA LOT 17, DISTRICT LOT 470, GROUP 1, NEW WESTMINSTER DISTRICT STRATA PLAN NW1808 TOGETHER WITH AN INTEREST IN THE COMMON PROPERTY IN PROPORTION TO THE UNIT ENTITLEMENT OF THE STRATA LOT AS SHOWN ON FORM V
235 BALMORAL PL	002-008-521	STRATA LOT 83, DISTRICT LOT 470, GROUP 1, NEW WESTMINSTER DISTRICT STRATA PLAN NW1808 TOGETHER WITH AN INTEREST IN THE COMMON PROPERTY IN PROPORTION TO THE UNIT ENTITLEMENT OF THE STRATA LOT AS SHOWN ON FORM V

Schedule A

Address	P.I.D.	Legal Description
236 BALMORAL PL	002-007-533	STRATA LOT 18, DISTRICT LOT 470, GROUP 1, NEW WESTMINSTER DISTRICT STRATA PLAN NW1808 TOGETHER WITH AN INTEREST IN THE COMMON PROPERTY IN PROPORTION TO THE UNIT ENTITLEMENT OF THE STRATA LOT AS SHOWN ON FORM V
237 BALMORAL PL	002-008-513	STRATA LOT 82, DISTRICT LOT 470, GROUP 1, NEW WESTMINSTER DISTRICT STRATA PLAN NW1808 TOGETHER WITH AN INTEREST IN THE COMMON PROPERTY IN PROPORTION TO THE UNIT ENTITLEMENT OF THE STRATA LOT AS SHOWN ON FORM V
238 BALMORAL PL	002-007-541	STRATA LOT 19, DISTRICT LOT 470, GROUP 1, NEW WESTMINSTER DISTRICT STRATA PLAN NW1808 TOGETHER WITH AN INTEREST IN THE COMMON PROPERTY IN PROPORTION TO THE UNIT ENTITLEMENT OF THE STRATA LOT AS SHOWN ON FORM V
239 BALMORAL PL	002-008-505	STRATA LOT 81, DISTRICT LOT 470, GROUP 1, NEW WESTMINSTER DISTRICT STRATA PLAN NW1808 TOGETHER WITH AN INTEREST IN THE COMMON PROPERTY IN PROPORTION TO THE UNIT ENTITLEMENT OF THE STRATA LOT AS SHOWN ON FORM V
240 BALMORAL PL	002-007-550	STRATA LOT 20, DISTRICT LOT 470, GROUP 1, NEW WESTMINSTER DISTRICT STRATA PLAN NW1808 TOGETHER WITH AN INTEREST IN THE COMMON PROPERTY IN PROPORTION TO THE UNIT ENTITLEMENT OF THE STRATA LOT AS SHOWN ON FORM V
241 BALMORAL PL	002-008-475	STRATA LOT 80, DISTRICT LOT 470, GROUP 1, NEW WESTMINSTER DISTRICT STRATA PLAN NW1808 TOGETHER WITH AN INTEREST IN THE COMMON PROPERTY IN PROPORTION TO THE UNIT ENTITLEMENT OF THE STRATA LOT AS SHOWN ON FORM V
242 BALMORAL PL	002-007-568	STRATA LOT 21, DISTRICT LOT 470, GROUP 1, NEW WESTMINSTER DISTRICT STRATA PLAN NW1808 TOGETHER WITH AN INTEREST IN THE COMMON PROPERTY IN PROPORTION TO THE UNIT ENTITLEMENT OF THE STRATA LOT AS SHOWN ON FORM V

Schedule A

Address	P.I.D.	Legal Description
243 BALMORAL PL	002-008-467	STRATA LOT 79, DISTRICT LOT 470, GROUP 1, NEW WESTMINSTER DISTRICT STRATA PLAN NW1808 TOGETHER WITH AN INTEREST IN THE COMMON PROPERTY IN PROPORTION TO THE UNIT ENTITLEMENT OF THE STRATA LOT AS SHOWN ON FORM V
244 BALMORAL PL	002-007-576	STRATA LOT 22, DISTRICT LOT 470, GROUP 1, NEW WESTMINSTER DISTRICT STRATA PLAN NW1808 TOGETHER WITH AN INTEREST IN THE COMMON PROPERTY IN PROPORTION TO THE UNIT ENTITLEMENT OF THE STRATA LOT AS SHOWN ON FORM V
245 BALMORAL PL	002-008-441	STRATA LOT 78, DISTRICT LOT 470, GROUP 1, NEW WESTMINSTER DISTRICT STRATA PLAN NW1808 TOGETHER WITH AN INTEREST IN THE COMMON PROPERTY IN PROPORTION TO THE UNIT ENTITLEMENT OF THE STRATA LOT AS SHOWN ON FORM V
246 BALMORAL PL	002-007-584	STRATA LOT 23, DISTRICT LOT 470, GROUP 1, NEW WESTMINSTER DISTRICT STRATA PLAN NW1808 TOGETHER WITH AN INTEREST IN THE COMMON PROPERTY IN PROPORTION TO THE UNIT ENTITLEMENT OF THE STRATA LOT AS SHOWN ON FORM V
247 BALMORAL PL	002-008-432	STRATA LOT 77, DISTRICT LOT 470, GROUP 1, NEW WESTMINSTER DISTRICT STRATA PLAN NW1808 TOGETHER WITH AN INTEREST IN THE COMMON PROPERTY IN PROPORTION TO THE UNIT ENTITLEMENT OF THE STRATA LOT AS SHOWN ON FORM V
248 BALMORAL PL	002-007-592	STRATA LOT 24, DISTRICT LOT 470, GROUP 1, NEW WESTMINSTER DISTRICT STRATA PLAN NW1808 TOGETHER WITH AN INTEREST IN THE COMMON PROPERTY IN PROPORTION TO THE UNIT ENTITLEMENT OF THE STRATA LOT AS SHOWN ON FORM V
249 BALMORAL PL	002-008-424	STRATA LOT 76, DISTRICT LOT 470, GROUP 1, NEW WESTMINSTER DISTRICT STRATA PLAN NW1808 TOGETHER WITH AN INTEREST IN THE COMMON PROPERTY IN PROPORTION TO THE UNIT ENTITLEMENT OF THE STRATA LOT AS SHOWN ON FORM V

Schedule A

Address	P.I.D.	Legal Description
250 BALMORAL PL	002-007-606	STRATA LOT 25, DISTRICT LOT 470, GROUP 1, NEW WESTMINSTER DISTRICT STRATA PLAN NW1808 TOGETHER WITH AN INTEREST IN THE COMMON PROPERTY IN PROPORTION TO THE UNIT ENTITLEMENT OF THE STRATA LOT AS SHOWN ON FORM V
251 BALMORAL PL	002-008-416	STRATA LOT 75, DISTRICT LOT 470, GROUP 1, NEW WESTMINSTER DISTRICT STRATA PLAN NW1808 TOGETHER WITH AN INTEREST IN THE COMMON PROPERTY IN PROPORTION TO THE UNIT ENTITLEMENT OF THE STRATA LOT AS SHOWN ON FORM V
252 BALMORAL PL	002-007-649	STRATA LOT 26, DISTRICT LOT 470, GROUP 1, NEW WESTMINSTER DISTRICT STRATA PLAN NW1808 TOGETHER WITH AN INTEREST IN THE COMMON PROPERTY IN PROPORTION TO THE UNIT ENTITLEMENT OF THE STRATA LOT AS SHOWN ON FORM V
253 BALMORAL PL	002-008-408	STRATA LOT 74, DISTRICT LOT 470, GROUP 1, NEW WESTMINSTER DISTRICT STRATA PLAN NW1808 TOGETHER WITH AN INTEREST IN THE COMMON PROPERTY IN PROPORTION TO THE UNIT ENTITLEMENT OF THE STRATA LOT AS SHOWN ON FORM V
254 BALMORAL PL	002-007-657	STRATA LOT 27, DISTRICT LOT 470, GROUP 1, NEW WESTMINSTER DISTRICT STRATA PLAN NW1808 TOGETHER WITH AN INTEREST IN THE COMMON PROPERTY IN PROPORTION TO THE UNIT ENTITLEMENT OF THE STRATA LOT AS SHOWN ON FORM V
255 BALMORAL PL	002-008-386	STRATA LOT 73, DISTRICT LOT 470, GROUP 1, NEW WESTMINSTER DISTRICT STRATA PLAN NW1808 TOGETHER WITH AN INTEREST IN THE COMMON PROPERTY IN PROPORTION TO THE UNIT ENTITLEMENT OF THE STRATA LOT AS SHOWN ON FORM V
256 BALMORAL PL	002-007-681	STRATA LOT 28, DISTRICT LOT 470, GROUP 1, NEW WESTMINSTER DISTRICT STRATA PLAN NW1808 TOGETHER WITH AN INTEREST IN THE COMMON PROPERTY IN PROPORTION TO THE UNIT ENTITLEMENT OF THE STRATA LOT AS SHOWN ON FORM V

Schedule A

Address	P.I.D.	Legal Description
257 BALMORAL PL	002-008-220	STRATA LOT 60, DISTRICT LOT 470, GROUP 1, NEW WESTMINSTER DISTRICT STRATA PLAN NW1808 TOGETHER WITH AN INTEREST IN THE COMMON PROPERTY IN PROPORTION TO THE UNIT ENTITLEMENT OF THE STRATA LOT AS SHOWN ON FORM V
258 BALMORAL PL	002-008-378	STRATA LOT 72, DISTRICT LOT 470, GROUP 1, NEW WESTMINSTER DISTRICT STRATA PLAN NW1808 TOGETHER WITH AN INTEREST IN THE COMMON PROPERTY IN PROPORTION TO THE UNIT ENTITLEMENT OF THE STRATA LOT AS SHOWN ON FORM V
259 BALMORAL PL	002-008-211	STRATA LOT 59, DISTRICT LOT 470, GROUP 1, NEW WESTMINSTER DISTRICT STRATA PLAN NW1808 TOGETHER WITH AN INTEREST IN THE COMMON PROPERTY IN PROPORTION TO THE UNIT ENTITLEMENT OF THE STRATA LOT AS SHOWN ON FORM V
260 BALMORAL PL	002-008-360	STRATA LOT 71, DISTRICT LOT 470, GROUP 1, NEW WESTMINSTER DISTRICT STRATA PLAN NW1808 TOGETHER WITH AN INTEREST IN THE COMMON PROPERTY IN PROPORTION TO THE UNIT ENTITLEMENT OF THE STRATA LOT AS SHOWN ON FORM V
261 BALMORAL PL	002-008-203	STRATA LOT 58, DISTRICT LOT 470, GROUP 1, NEW WESTMINSTER DISTRICT STRATA PLAN NW1808 TOGETHER WITH AN INTEREST IN THE COMMON PROPERTY IN PROPORTION TO THE UNIT ENTITLEMENT OF THE STRATA LOT AS SHOWN ON FORM V
262 BALMORAL PL	002-008-351	STRATA LOT 70, DISTRICT LOT 470, GROUP 1, NEW WESTMINSTER DISTRICT STRATA PLAN NW1808 TOGETHER WITH AN INTEREST IN THE COMMON PROPERTY IN PROPORTION TO THE UNIT ENTITLEMENT OF THE STRATA LOT AS SHOWN ON FORM V
263 BALMORAL PL	002-008-190	STRATA LOT 57, DISTRICT LOT 470, GROUP 1, NEW WESTMINSTER DISTRICT STRATA PLAN NW1808 TOGETHER WITH AN INTEREST IN THE COMMON PROPERTY IN PROPORTION TO THE UNIT ENTITLEMENT OF THE STRATA LOT AS SHOWN ON FORM V

Schedule A

Address	P.I.D.	Legal Description
264 BALMORAL PL	002-008-343	STRATA LOT 69, DISTRICT LOT 470, GROUP 1, NEW WESTMINSTER DISTRICT STRATA PLAN NW1808 TOGETHER WITH AN INTEREST IN THE COMMON PROPERTY IN PROPORTION TO THE UNIT ENTITLEMENT OF THE STRATA LOT AS SHOWN ON FORM V
265 BALMORAL PL	002-008-173	STRATA LOT 56, DISTRICT LOT 470, GROUP 1, NEW WESTMINSTER DISTRICT STRATA PLAN NW1808 TOGETHER WITH AN INTEREST IN THE COMMON PROPERTY IN PROPORTION TO THE UNIT ENTITLEMENT OF THE STRATA LOT AS SHOWN ON FORM V
266 BALMORAL PL	002-008-335	STRATA LOT 68, DISTRICT LOT 470, GROUP 1, NEW WESTMINSTER DISTRICT STRATA PLAN NW1808 TOGETHER WITH AN INTEREST IN THE COMMON PROPERTY IN PROPORTION TO THE UNIT ENTITLEMENT OF THE STRATA LOT AS SHOWN ON FORM V
267 BALMORAL PL	002-008-165	STRATA LOT 55, DISTRICT LOT 470, GROUP 1, NEW WESTMINSTER DISTRICT STRATA PLAN NW1808 TOGETHER WITH AN INTEREST IN THE COMMON PROPERTY IN PROPORTION TO THE UNIT ENTITLEMENT OF THE STRATA LOT AS SHOWN ON FORM V
268 BALMORAL PL	002-008-319	STRATA LOT 67, DISTRICT LOT 470, GROUP 1, NEW WESTMINSTER DISTRICT STRATA PLAN NW1808 TOGETHER WITH AN INTEREST IN THE COMMON PROPERTY IN PROPORTION TO THE UNIT ENTITLEMENT OF THE STRATA LOT AS SHOWN ON FORM V
269 BALMORAL PL	002-008-157	STRATA LOT 54, DISTRICT LOT 470, GROUP 1, NEW WESTMINSTER DISTRICT STRATA PLAN NW1808 TOGETHER WITH AN INTEREST IN THE COMMON PROPERTY IN PROPORTION TO THE UNIT ENTITLEMENT OF THE STRATA LOT AS SHOWN ON FORM V
270 BALMORAL PL	002-008-297	STRATA LOT 66, DISTRICT LOT 470, GROUP 1, NEW WESTMINSTER DISTRICT STRATA PLAN NW1808 TOGETHER WITH AN INTEREST IN THE COMMON PROPERTY IN PROPORTION TO THE UNIT ENTITLEMENT OF THE STRATA LOT AS SHOWN ON FORM V

Schedule A

Address	P.I.D.	Legal Description
271 BALMORAL PL	002-008-122	STRATA LOT 53, DISTRICT LOT 470, GROUP 1, NEW WESTMINSTER DISTRICT STRATA PLAN NW1808 TOGETHER WITH AN INTEREST IN THE COMMON PROPERTY IN PROPORTION TO THE UNIT ENTITLEMENT OF THE STRATA LOT AS SHOWN ON FORM V
272 BALMORAL PL	002-008-289	STRATA LOT 65, DISTRICT LOT 470, GROUP 1, NEW WESTMINSTER DISTRICT STRATA PLAN NW1808 TOGETHER WITH AN INTEREST IN THE COMMON PROPERTY IN PROPORTION TO THE UNIT ENTITLEMENT OF THE STRATA LOT AS SHOWN ON FORM V
273 BALMORAL PL	002-007-959	STRATA LOT 48, DISTRICT LOT 470, GROUP 1, NEW WESTMINSTER DISTRICT STRATA PLAN NW1808 TOGETHER WITH AN INTEREST IN THE COMMON PROPERTY IN PROPORTION TO THE UNIT ENTITLEMENT OF THE STRATA LOT AS SHOWN ON FORM V
274 BALMORAL PL	002-008-271	STRATA LOT 64, DISTRICT LOT 470, GROUP 1, NEW WESTMINSTER DISTRICT STRATA PLAN NW1808 TOGETHER WITH AN INTEREST IN THE COMMON PROPERTY IN PROPORTION TO THE UNIT ENTITLEMENT OF THE STRATA LOT AS SHOWN ON FORM V
275 BALMORAL PL	002-007-941	STRATA LOT 47, DISTRICT LOT 470, GROUP 1, NEW WESTMINSTER DISTRICT STRATA PLAN NW1808 TOGETHER WITH AN INTEREST IN THE COMMON PROPERTY IN PROPORTION TO THE UNIT ENTITLEMENT OF THE STRATA LOT AS SHOWN ON FORM V
276 BALMORAL PL	002-008-262	STRATA LOT 63, DISTRICT LOT 470, GROUP 1, NEW WESTMINSTER DISTRICT STRATA PLAN NW1808 TOGETHER WITH AN INTEREST IN THE COMMON PROPERTY IN PROPORTION TO THE UNIT ENTITLEMENT OF THE STRATA LOT AS SHOWN ON FORM V
277 BALMORAL PL	002-007-924	STRATA LOT 46, DISTRICT LOT 470, GROUP 1, NEW WESTMINSTER DISTRICT STRATA PLAN NW1808 TOGETHER WITH AN INTEREST IN THE COMMON PROPERTY IN PROPORTION TO THE UNIT ENTITLEMENT OF THE STRATA LOT AS SHOWN ON FORM V

Schedule A

Address	P.I.D.	Legal Description
278 BALMORAL PL	002-008-254	STRATA LOT 62, DISTRICT LOT 470, GROUP 1, NEW WESTMINSTER DISTRICT STRATA PLAN NW1808 TOGETHER WITH AN INTEREST IN THE COMMON PROPERTY IN PROPORTION TO THE UNIT ENTITLEMENT OF THE STRATA LOT AS SHOWN ON FORM V
279 BALMORAL PL	002-007-916	STRATA LOT 45, DISTRICT LOT 470, GROUP 1, NEW WESTMINSTER DISTRICT STRATA PLAN NW1808 TOGETHER WITH AN INTEREST IN THE COMMON PROPERTY IN PROPORTION TO THE UNIT ENTITLEMENT OF THE STRATA LOT AS SHOWN ON FORM V
280 BALMORAL PL	002-008-246	STRATA LOT 61, DISTRICT LOT 470, GROUP 1, NEW WESTMINSTER DISTRICT STRATA PLAN NW1808 TOGETHER WITH AN INTEREST IN THE COMMON PROPERTY IN PROPORTION TO THE UNIT ENTITLEMENT OF THE STRATA LOT AS SHOWN ON FORM V
281 BALMORAL PL	002-007-908	STRATA LOT 44, DISTRICT LOT 470, GROUP 1, NEW WESTMINSTER DISTRICT STRATA PLAN NW1808 TOGETHER WITH AN INTEREST IN THE COMMON PROPERTY IN PROPORTION TO THE UNIT ENTITLEMENT OF THE STRATA LOT AS SHOWN ON FORM V
282 BALMORAL PL	002-008-114	STRATA LOT 52, DISTRICT LOT 470, GROUP 1, NEW WESTMINSTER DISTRICT STRATA PLAN NW1808 TOGETHER WITH AN INTEREST IN THE COMMON PROPERTY IN PROPORTION TO THE UNIT ENTITLEMENT OF THE STRATA LOT AS SHOWN ON FORM V
283 BALMORAL PL	002-007-894	STRATA LOT 43, DISTRICT LOT 470, GROUP 1, NEW WESTMINSTER DISTRICT STRATA PLAN NW1808 TOGETHER WITH AN INTEREST IN THE COMMON PROPERTY IN PROPORTION TO THE UNIT ENTITLEMENT OF THE STRATA LOT AS SHOWN ON FORM V
284 BALMORAL PL	002-008-092	STRATA LOT 51, DISTRICT LOT 470, GROUP 1, NEW WESTMINSTER DISTRICT STRATA PLAN NW1808 TOGETHER WITH AN INTEREST IN THE COMMON PROPERTY IN PROPORTION TO THE UNIT ENTITLEMENT OF THE STRATA LOT AS SHOWN ON FORM V

Schedule A

Address	P.I.D.	Legal Description
285 BALMORAL PL	002-007-886	STRATA LOT 42, DISTRICT LOT 470, GROUP 1, NEW WESTMINSTER DISTRICT STRATA PLAN NW1808 TOGETHER WITH AN INTEREST IN THE COMMON PROPERTY IN PROPORTION TO THE UNIT ENTITLEMENT OF THE STRATA LOT AS SHOWN ON FORM V
286 BALMORAL PL	002-008-084	STRATA LOT 50, DISTRICT LOT 470, GROUP 1, NEW WESTMINSTER DISTRICT STRATA PLAN NW1808 TOGETHER WITH AN INTEREST IN THE COMMON PROPERTY IN PROPORTION TO THE UNIT ENTITLEMENT OF THE STRATA LOT AS SHOWN ON FORM V
287 BALMORAL PL	002-007-878	STRATA LOT 41, DISTRICT LOT 470, GROUP 1, NEW WESTMINSTER DISTRICT STRATA PLAN NW1808 TOGETHER WITH AN INTEREST IN THE COMMON PROPERTY IN PROPORTION TO THE UNIT ENTITLEMENT OF THE STRATA LOT AS SHOWN ON FORM V
288 BALMORAL PL	002-007-975	STRATA LOT 49, DISTRICT LOT 470, GROUP 1, NEW WESTMINSTER DISTRICT STRATA PLAN NW1808 TOGETHER WITH AN INTEREST IN THE COMMON PROPERTY IN PROPORTION TO THE UNIT ENTITLEMENT OF THE STRATA LOT AS SHOWN ON FORM V