

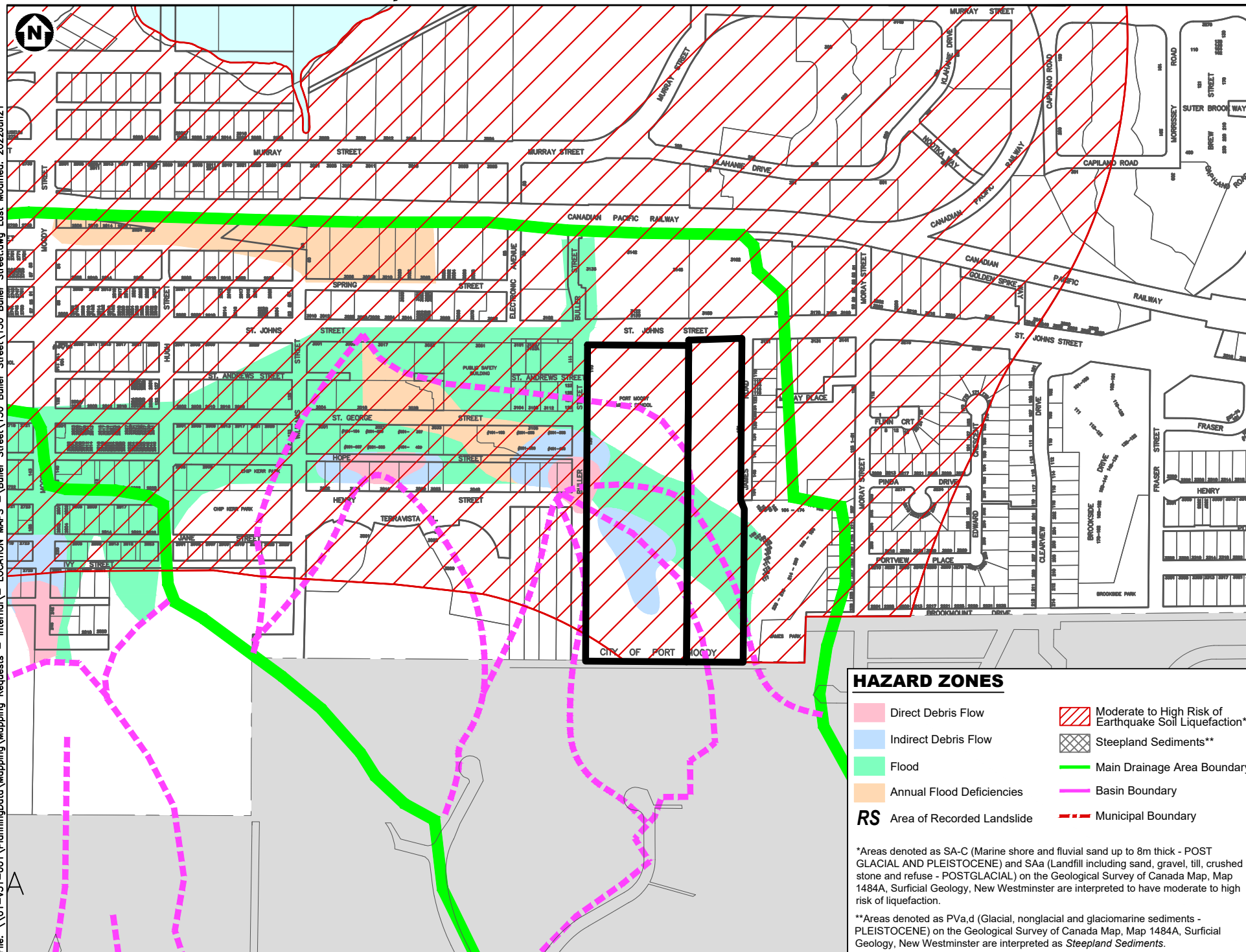







# OCP Hazardous Lands Map - 130 Buller Street & 131 James Rd

 **SUBJECT PROPERTY**

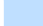
File: \\01-V51-001\PlanningData\Mapping\Requests - Internal\ - LOCATION MAPS - Buller Street\130 Buller Street.dwg Last Modified: 2022Jun21



## HAZARD ZONES

- |   |  |
|---|--|
|  Direct Debris Flow        |  Moderate to High Risk of Earthquake Soil Liquefaction* |
|  Indirect Debris Flow      |  Steepland Sediments**                                  |
|  Flood                     |  Main Drainage Area Boundary                            |
|  Annual Flood Deficiencies |  Basin Boundary   |
| <b>RS</b> Area of Recorded Landslide  |  Municipal Boundary                                     |

\*Areas denoted as SA-C (Marine shore and fluvial sand up to 8m thick - POST GLACIAL AND PLEISTOCENE) and SAa (Landfill including sand, gravel, till, crushed stone and refuse - POSTGLACIAL) on the Geological Survey of Canada Map, Map 1484A, Surficial Geology, New Westminster are interpreted to have moderate to high risk of liquefaction.

\*\*Areas denoted as PVA,d (Glacial, nonglacial and glaciomarine sediments - PLEISTOCENE) on the Geological Survey of Canada Map, Map 1484A, Surficial Geology, New Westminster are interpreted as Steepland Sediments.