



# City of Port Moody

## **Bylaw No. 3356**

A Bylaw to apply North Shore Single Detached Residential (RS3) and Civic Service (P1) Zoning to the properties previously subject to a Land Use Contract for Appleyard Court.

The Council of the City of Port Moody enacts as follows:

### **1. Citation**

- 1.1 This Bylaw may be cited as “City of Port Moody Zoning Bylaw, 2018, No. 2937, Amendment Bylaw No. 70, 2022, No. 3356 (Appleyard Court) (RS3 and P1)”.

### **2. Amendments**

- 2.1 City of Port Moody Zoning Bylaw, 2018, No. 2937 is amended by rezoning the lands outlined in the following schedule to North Shore Single Detached Residential (RS3):
  - Schedule A – Appleyard Court Map and List of Properties.
- 2.2 City of Port Moody Zoning Bylaw, 2018, No. 2937 is further amended by rezoning the following lands to Civic Service (P1):

LOT 354, DISTRICT LOT 470, GROUP 1, NEW WEST DISTRICT PLAN  
54963 (PID: 005-289-441)

as shown on the map in Schedule A of this Bylaw.

### **3. Attachments and Schedules**

- 3.1 The following schedule is attached to and forms part of this Bylaw:
  - Schedule A – Appleyard Court Map and List of Properties.

### **4. Severability**

- 4.1 If a portion of this Bylaw is found invalid by a court, it will be severed and the remainder of the Bylaw will remain in effect.

### **5. Effective Date**

- 5.1 This Bylaw shall come into effect one year after the date of adoption.

**Read a first time** this 10<sup>th</sup> day of May, 2022.

**Read a second time** this 10<sup>th</sup> day of May, 2022.

**Public Hearing held** this \_\_\_ day of \_\_\_\_\_, 2022.

**Read a third time** this \_\_\_ day of \_\_\_\_\_, 2022.

**Adopted** this \_\_\_ day of \_\_\_\_\_, 2022.

---

R. Vagramov  
Mayor

---

D. Shermer  
Corporate Officer

I hereby certify that the above is a true copy of Bylaw No. 3356 of the City of Port Moody.

---

D. Shermer  
Corporate Officer

**Schedule A – Appleyard Court Map and List of Properties**

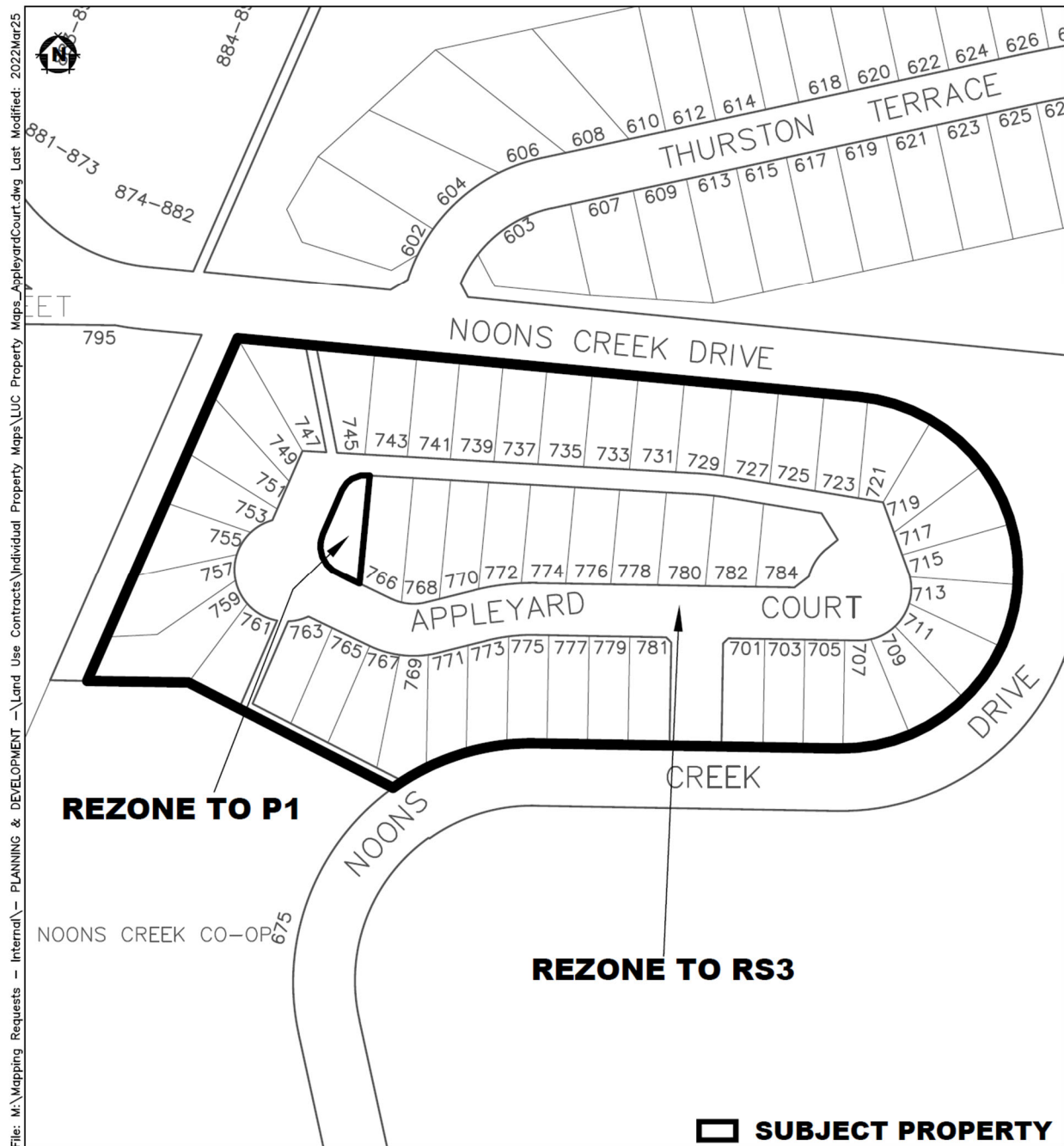

## Schedule A

### List of Properties

Address	P.I.D.	Legal Description
701 Appleyard Court	005-295-181	LOT 303 DISTRICT LOT 470 GROUP 1 NEW WESTMINSTER DISTRICT PLAN 54963
703 Appleyard Court	005-295-220	LOT 304 DISTRICT LOT 470 GROUP 1 NEW WESTMINSTER DISTRICT PLAN 54963
705 Appleyard Court	001-739-883	LOT 305 DISTRICT LOT 470 GROUP 1 NEW WESTMINSTER DISTRICT PLAN 54963
707 Appleyard Court	002-044-871	LOT 306 DISTRICT LOT 470 GROUP 1 NEW WESTMINSTER DISTRICT PLAN 54963
709 Appleyard Court	005-295-262	LOT 307 DISTRICT LOT 470 GROUP 1 NEW WESTMINSTER DISTRICT PLAN 54963
711 Appleyard Court	005-295-335	LOT 308 DISTRICT LOT 470 GROUP 1 NEW WESTMINSTER DISTRICT PLAN 54963
713 Appleyard Court	005-295-360	LOT 309 DISTRICT LOT 470 GROUP 1 NEW WESTMINSTER DISTRICT PLAN 54963
715 Appleyard Court	005-295-386	LOT 310 DISTRICT LOT 470 GROUP 1 NEW WESTMINSTER DISTRICT PLAN 54963
717 Appleyard Court	005-295-424	LOT 311 DISTRICT LOT 470 GROUP 1 NEW WESTMINSTER DISTRICT PLAN 54963
719 Appleyard Court	001-499-408	LOT 312 DISTRICT LOT 470 GROUP 1 NEW WESTMINSTER DISTRICT PLAN 54963
721 Appleyard Court	001-478-273	LOT 313 DISTRICT LOT 470 GROUP 1 NEW WESTMINSTER DISTRICT PLAN 54963
723 Appleyard Court	005-294-631	LOT 314 DISTRICT LOT 470 GROUP 1 NEW WESTMINSTER DISTRICT PLAN 54963
725 Appleyard Court	005-295-467	LOT 315 DISTRICT LOT 470 GROUP 1 NEW WESTMINSTER DISTRICT PLAN 54963
727 Appleyard Court	005-295-491	LOT 316 DISTRICT LOT 470 GROUP 1 NEW WESTMINSTER DISTRICT PLAN 54963
729 Appleyard Court	005-295-513	LOT 317 DISTRICT LOT 470 GROUP 1 NEW WESTMINSTER DISTRICT PLAN 54963
731 Appleyard Court	005-295-556	LOT 318 DISTRICT LOT 470 GROUP 1 NEW WESTMINSTER DISTRICT PLAN 54963
733 Appleyard Court	005-295-581	LOT 319 DISTRICT LOT 470 GROUP 1 NEW WESTMINSTER DISTRICT PLAN 54963
735 Appleyard Court	005-295-611	LOT 320 DISTRICT LOT 470 GROUP 1 NEW WESTMINSTER DISTRICT PLAN 54963
737 Appleyard Court	005-295-629	LOT 321 DISTRICT LOT 470 GROUP 1 NEW WESTMINSTER DISTRICT PLAN 54963
739 Appleyard Court	005-295-645	LOT 322 DISTRICT LOT 470 GROUP 1 NEW WESTMINSTER DISTRICT PLAN 54963
741 Appleyard Court	005-295-670	LOT 323 DISTRICT LOT 470 GROUP 1 NEW WESTMINSTER DISTRICT PLAN 54963
743 Appleyard Court	005-295-700	LOT 324 DISTRICT LOT 470 GROUP 1 NEW WESTMINSTER DISTRICT PLAN 54963

Schedule A

Address	P.I.D.	Legal Description
745 Appleyard Court	003-053-229	LOT 325 DISTRICT LOT 470 GROUP 1 NEW WESTMINSTER DISTRICT PLAN 54963
747 Appleyard Court	000-599-573	LOT 326 DISTRICT LOT 470 GROUP 1 NEW WESTMINSTER DISTRICT PLAN 54963
749 Appleyard Court	004-623-321	LOT 327 DISTRICT LOT 470 GROUP 1 NEW WESTMINSTER DISTRICT PLAN 54963
751 Appleyard Court	005-295-726	LOT 328 DISTRICT LOT 470 GROUP 1 NEW WESTMINSTER DISTRICT PLAN 54963
753 Appleyard Court	001-303-716	LOT 329 DISTRICT LOT 470 GROUP 1 NEW WESTMINSTER DISTRICT PLAN 54963
755 Appleyard Court	005-295-742	LOT 330 DISTRICT LOT 470 GROUP 1 NEW WESTMINSTER DISTRICT PLAN 54963
757 Appleyard Court	005-295-751	LOT 331 DISTRICT LOT 470 GROUP 1 NEW WESTMINSTER DISTRICT PLAN 54963
759 Appleyard Court	002-785-153	LOT 332 OF DISTRICT LOT 470 GROUP 1 NEW WESTMINSTER DISTRICT PLAN 54963
761 Appleyard Court	000-466-859	LOT 333 DISTRICT LOT 470 GROUP 1 NEW WESTMINSTER DISTRICT PLAN 54963
763 Appleyard Court	005-295-785	LOT 334 DISTRICT LOT 470 GROUP 1 NEW WESTMINSTER DISTRICT PLAN 54963
765 Appleyard Court	005-295-793	LOT 335 DISTRICT LOT 470 GROUP 1 NEW WESTMINSTER DISTRICT PLAN 54963
766 Appleyard Court	005-289-424	LOT 353 DISTRICT LOT 470 GROUP 1 NEW WESTMINSTER DISTRICT PLAN 54963
767 Appleyard Court	000-501-182	LOT 336 DISTRICT LOT 470 GROUP 1 NEW WESTMINSTER DISTRICT PLAN 54963
768 Appleyard Court	005-289-394	LOT 352 DISTRICT LOT 470 GROUP 1 NEW WESTMINSTER DISTRICT PLAN 54963
769 Appleyard Court	005-288-967	LOT 337 DISTRICT LOT 470 GROUP 1 NEW WESTMINSTER DISTRICT PLAN 54963
770 Appleyard Court	005-289-360	LOT 351 DISTRICT LOT 470 GROUP 1 NEW WESTMINSTER DISTRICT PLAN 54963
771 Appleyard Court	005-289-068	LOT 338 DISTRICT LOT 470 GROUP 1 NEW WESTMINSTER DISTRICT PLAN 54963
772 Appleyard Court	004-839-901	LOT 350 DISTRICT LOT 470 GROUP 1 NEW WESTMINSTER DISTRICT PLAN 54963
773 Appleyard Court	005-289-106	LOT 339 DISTRICT LOT 470 GROUP 1 NEW WESTMINSTER DISTRICT PLAN 54963
774 Appleyard Court	005-289-327	LOT 349 DISTRICT LOT 470 GROUP 1 NEW WESTMINSTER DISTRICT PLAN 54963
775 Appleyard Court	005-289-131	LOT 340 DISTRICT LOT 470 GROUP 1 NEW WESTMINSTER DISTRICT PLAN 54963
776 Appleyard Court	002-168-570	LOT 348 DISTRICT LOT 470 GROUP 1 NEW WESTMINSTER DISTRICT PLAN 54963
777 Appleyard Court	005-289-165	LOT 341 DISTRICT LOT 470 GROUP 1 NEW WESTMINSTER DISTRICT PLAN 54963

## Schedule A

<b>Address</b>	<b>P.I.D.</b>	<b>Legal Description</b>
778 Appleyard Court	002-248-247	LOT 347 DISTRICT LOT 470 GROUP 1 NEW WESTMINSTER DISTRICT PLAN 54963
779 Appleyard Court	005-289-181	LOT 342 DISTRICT LOT 470 GROUP 1 NEW WESTMINSTER DISTRICT PLAN 54963
780 Appleyard Court	005-289-297	LOT 346 DISTRICT LOT 470 GROUP 1 NEW WESTMINSTER DISTRICT PLAN 54963
781 Appleyard Court	005-289-190	LOT 343 DISTRICT LOT 470 GROUP 1 NEW WESTMINSTER DISTRICT PLAN 54963
782 Appleyard Court	005-289-238	LOT 345 DISTRICT LOT 470 GROUP 1 NEW WESTMINSTER DISTRICT PLAN 54963
784 Appleyard Court	004-856-872	LOT 344 DISTRICT LOT 470 GROUP 1 NEW WESTMINSTER DISTRICT PLAN 54963